

Remove the JP1 Jumper for use in CFT22XX models.

Tell Me what each wire is:

Wire #1 is: +5 Volt DC Power.

Wire #2 is: (FSK) Data Out.

Wire #3 is: - Negative Ground.

Wire #4 is: Serial Read (for 22XX models Only)

Wire #5 is: (FSK) Data In

Installation

- ✓ Before you Start. UN-PLUG the Power of your Box before removing the Lid.
- ✓ Using a Line-head #3 Tool, remove the 4 screws located under each corner of your box.
- ✓ Locate the drawing below that is the closest to the model # and resemblance to your Box.
- ✓ Solder Wire #1 to a Positive +5 Volt DC Power Source. (Be sure to check it with a Meter).
 - ✓ Solder Wire #2 to the FSK Data out pin like in the appropriate diagram below.
 - ✓ Solder Wire #3 to a Negative Ground Source Like in the appropriate Diagram below.
- ✓ Wire #4: Only when and if you have a CFT22xx series converter, will you use wire #4. Wire #4 will solder to a pin that is located inside the tuner for serial # read. Remove the side cover of the "CABLE OUT" or "TO TV" tuner. Once you remove the cover it will look like Diagram 10 below. The drawing shows the Left cover removed but on some models you will remove the right side cover instead. The pin that you solder wire #4 to depends on how long the tuner is. Look at Diagram 10 below and follow the directions. Do not cut the Pin in half, just solder it on.
 - ✓ Solder Wire #5 to the FSK Data In pin like in the appropriate diagram below.

Note: If installed correctly 02 will appear on the display.

- ✓ If your box is a CFT22XX series box, remove Jumper, JP1 on the test Kit by gently pulling up.
- ✓ With JP1 Jumper OFF for CFT22XX boxes, it will take at least 10 minutes for 02 to appear.
- ✓ With JP1 Jumper ON for Non CFT22XX boxes, it will take about 15 seconds for 02 to appear.

Once Your Done:

Power on the box and wait the appropriate amount of time so that the box will Boot on Automatically. Once it boots on you know that the installation was successful. If it did not boot on, then check your wiring and connections. Each chip is Bench tested before shipment to insure that each one works. Let the box map the channels and adjust itself to the proper settings.

(1) DPBB7312/V5, DPBB7522/V5

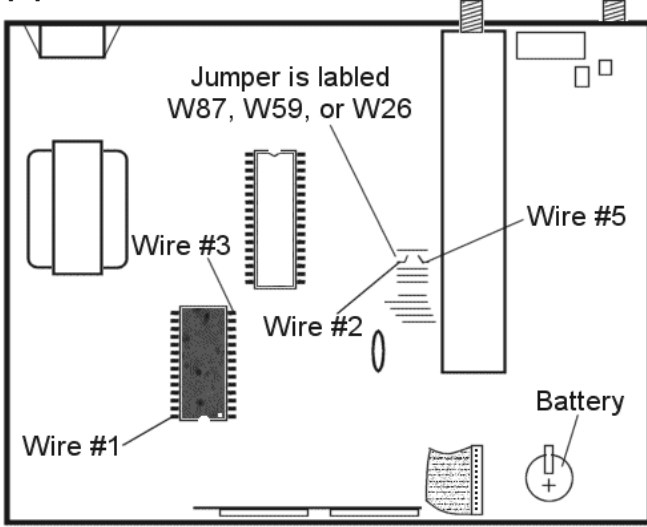

(2) DPV7212/V5, DPV7312/V5

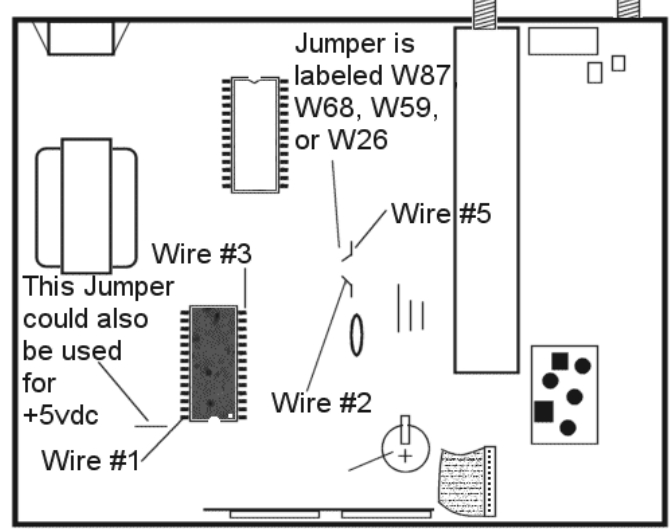

(3) DPV7212P/R2, DPV7113P/R2

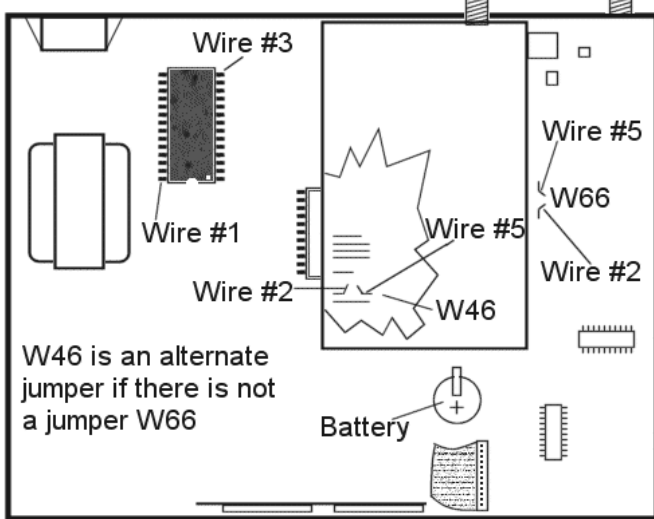

(4) CFT-2014/TIS8

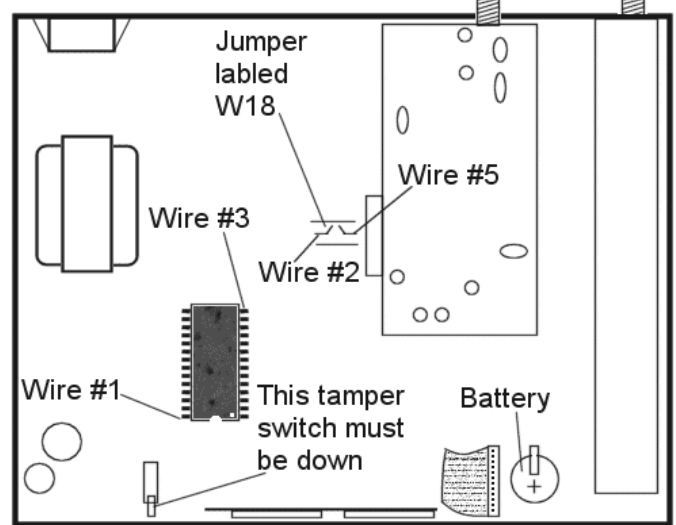

(5) CFT2014/V5S8, CFT2024/V5S8

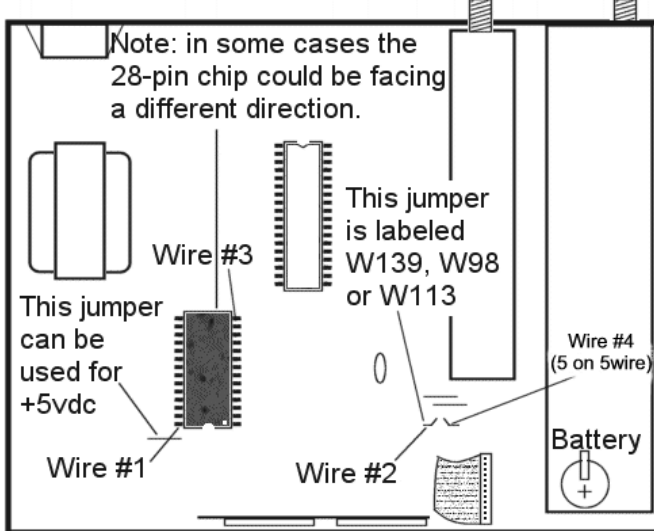

(6) DPBB731?P/R2S8

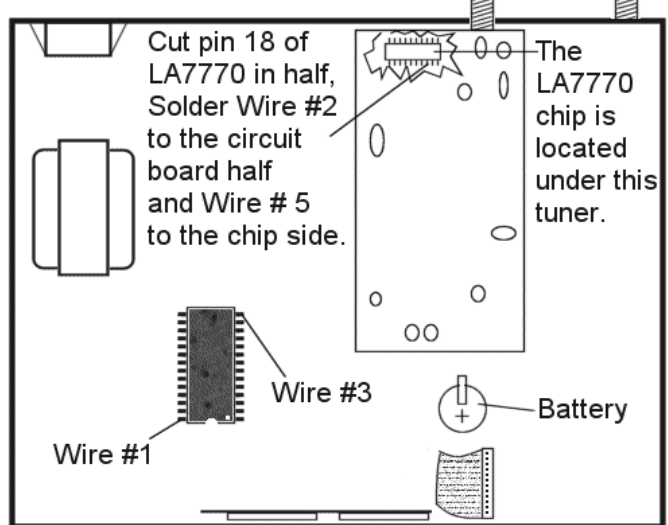

(7) All non R2, V5, or CFT Models

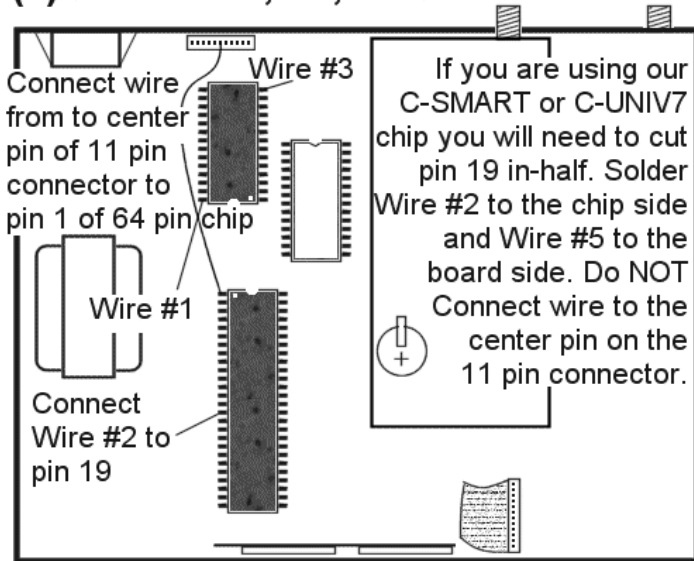

(8) CFT22xx Ver. 1 (older boxes)

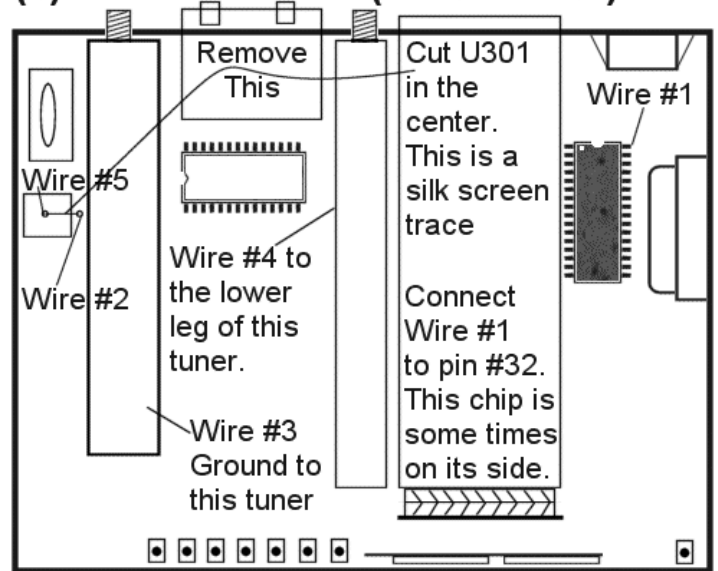

(9) CFT22xx Ver. 2 (Newer boxes)

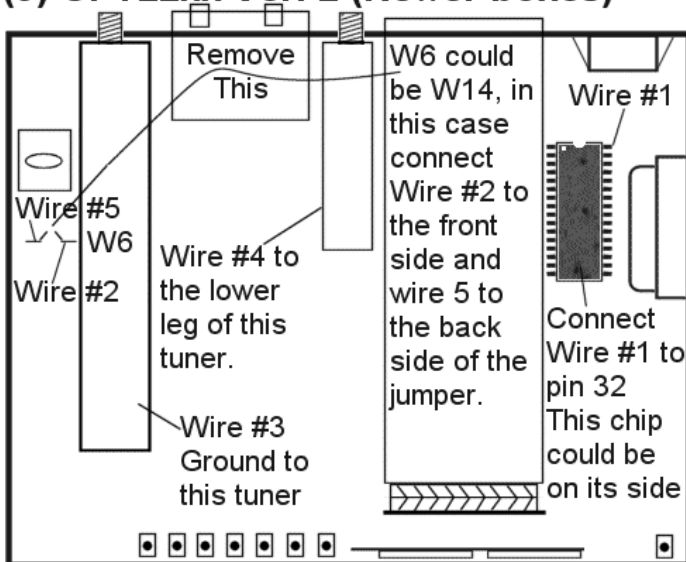

(10) CFT22XX, Wire #4 Solder Location.

